

SITE STATISTICS	
SITE AREA	8.27 ACRES
BUILDING AREAS	
OFFICE 'A'	8,483 SQ.FT.
OFFICE 'B'	4,211 SQ.FT.
WAREHOUSE 'B'	43,048 SQ.FT.
WAREHOUSE 'A'	93,944 SQ.FT.
COMMON AREAS (ELECT. SPRINKLER RM.)	506 SQ.FT.
PARKING SHOWN 80 CARS	
TOTAL BUILDING AREA	150,192 SQ.FT.

WAREHOUSE 'B' - TRUCK LEVEL DOORS W/ LEVELLERS (8'x10')	6
WAREHOUSE 'B' - DRIVE-IN DOOR (12'x14')	1
WAREHOUSE 'A' TRUCK LEVEL DOORS W/ LEVELLERS (8'x10')	6
WAREHOUSE 'A' DRIVE-IN DOOR (8'x10')	1
WAREHOUSE 'A' - DRIVE-IN DOOR (12'x14')	5

AREAS SHOWN ARE APPROXIMATE AND FOR PRELIMINARY USE ONLY.

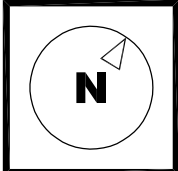
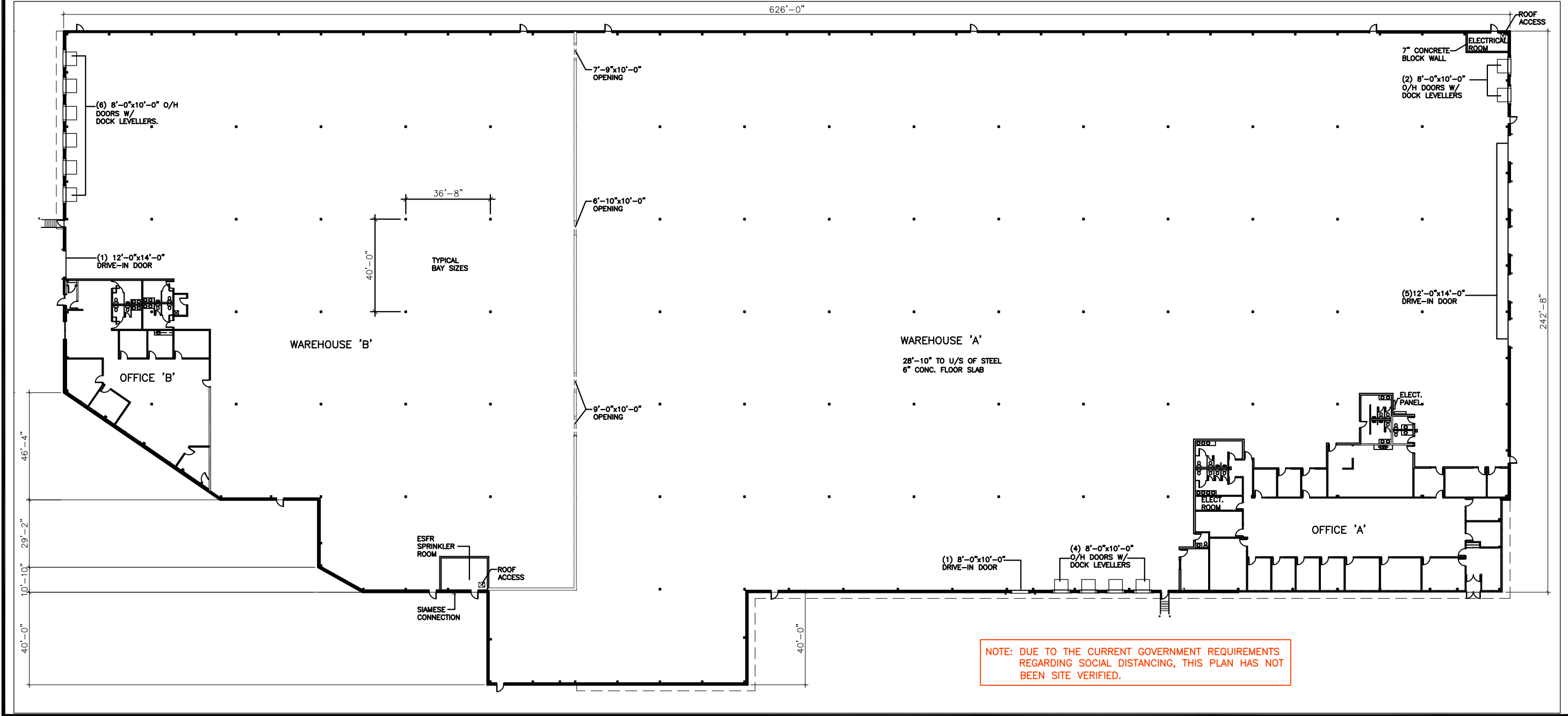
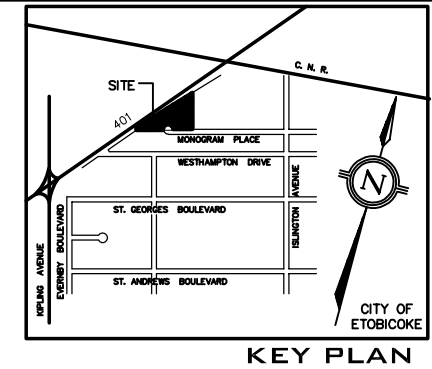

26 MONOGRAM PLACE
ETOBICOKE, ONTARIO

OVERALL PLAN

SCALE: 1"=20'-0"
DATE: APRIL 2, 2020