

KEY PLAN (NTS)

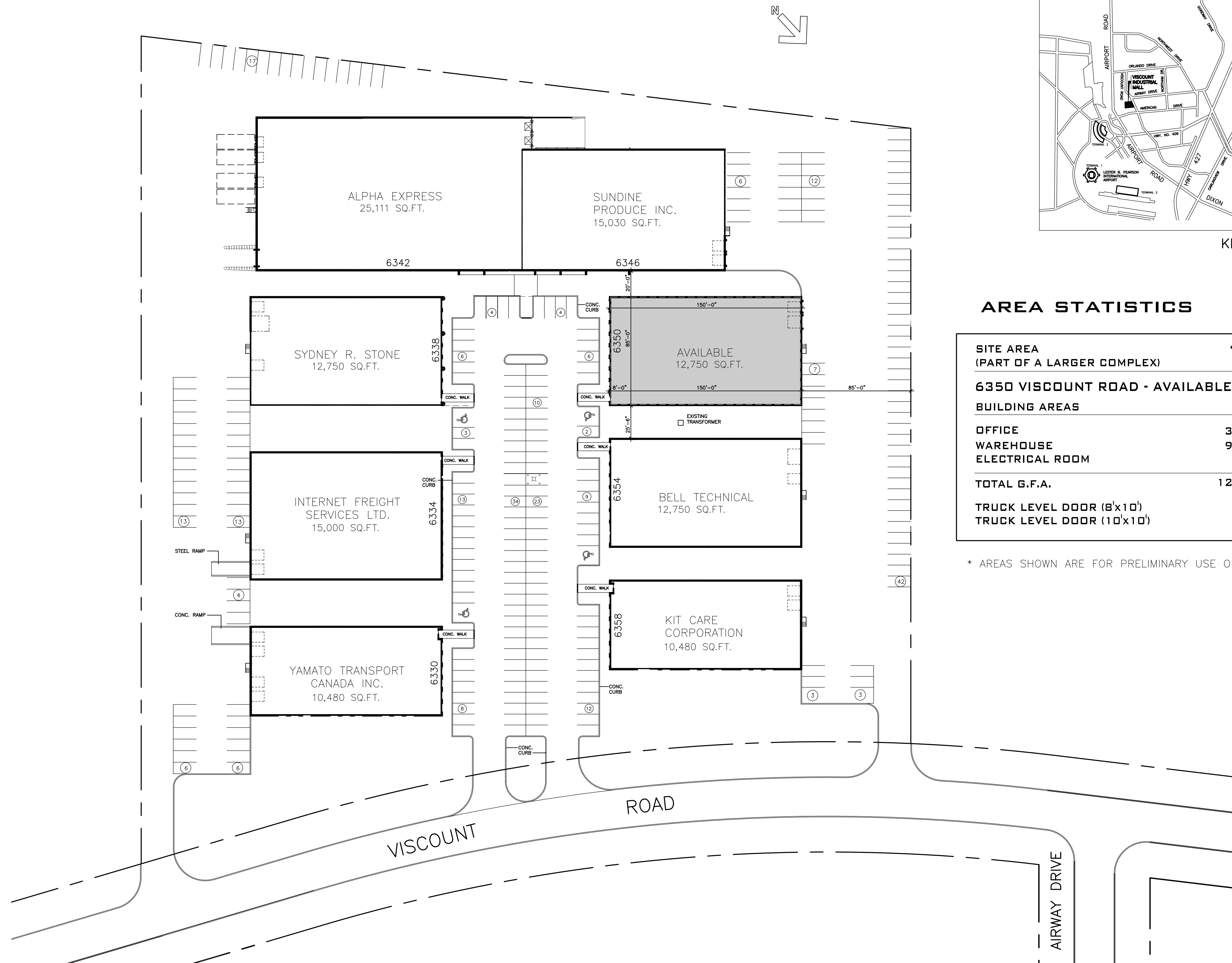

**AREA STATISTICS**

|   |                      |
|---|----------------------|
| SITE AREA<br>(PART OF A LARGER COMPLEX) | 7.50 ACRES           |
| <b>6350 VISCOUNT ROAD - AVAILABLE</b>   |                      |
| <b>BUILDING AREAS</b>                   |                      |
| OFFICE                                  | 3,441 SQ.FT.         |
| WAREHOUSE                               | 9,190 SQ.FT.         |
| ELECTRICAL ROOM                         | 119 SQ.FT.           |
| <b>TOTAL G.F.A.</b>                     | <b>12,750 SQ.FT.</b> |
| TRUCK LEVEL DOOR (8'x10')               | 1                    |
| TRUCK LEVEL DOOR (10'x10')              | 1                    |

\* AREAS SHOWN ARE FOR PRELIMINARY USE ONLY

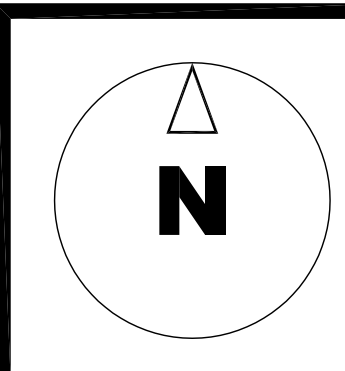

**VISCOUNT INDUSTRIAL MALL**  
MISSISSAUGA, ONTARIO

**SITE PLAN**

SCALE: 1"=40'-0"  
DATE: SEPT. 6, 2017